

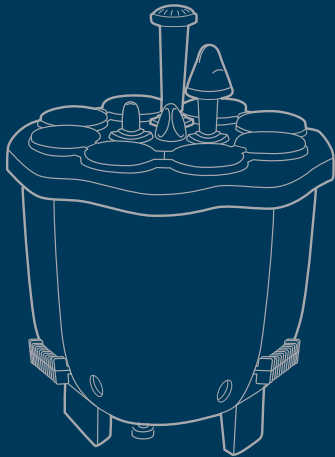

BRINGING WATER TO LIFE



MODEL MF201-01

TRANQUILITY FOUNTAIN FOR PONDS  
INSTRUCTION BOOKLET  
ENGLISH • ESPAÑOL • FRANCAIS

# THE TOBA MAGIC FOUNTAIN™

MODEL MF201-01



TOBA  
FOUNTAINS

BRINGING WATER TO LIFE

## INSTRUCTIONS AND CARE

Carefully read all instructions before operating the fountain. If you have any questions, please visit [www.tobafountains.com](http://www.tobafountains.com) or call our toll free number: 800-985-TOBA.



## PACKAGE CONTENTS:

Carefully unpack the fountain and all accessory items. It is recommended to keep the packaging materials in case you need to return your unit for service at some point in the future.

### PACKAGE CONTENTS:

- 8 Colored Lenses (Red, Blue, Yellow, Green)
- Fountain unit with attached cable
- Power Supply
- 4 Fountain Heads
- Remote Control
- Anchor with Cord and Hook
- Anchor Positioner Hook
- Document Package



## IMPORTANT

*Read all instructions before operating the unit.*

*This fountain is not intended for use where people are swimming.*

*This device is not rated for use in a marine environment. Use in saltwater will void the warranty.*

*The Toba Magic Fountain is designed to operate on low voltage (12 volts), similar to many outdoor garden lighting systems. Use the same care that you would when handling any electrical device to prevent the housing from being damaged and to prevent water from entering the dry areas of the fountain.*

*Replace bulbs with 12 volt MR-11 Halogen bulbs – 20 watts MAXIMUM.*

***DO NOT USE BULBS HIGHER THAN 20 WATTS.***

## SETTING UP YOUR MAGIC FOUNTAIN:

The Power Supply comes in a weatherproof box. It must be mounted to a vertical surface such as a wall or a post with the cables at the bottom of the unit. Choose a location away from heavy direct sprinklers.

**STEP 1:** With the power switch in the off position and the power cord unplugged, mount the box on a post or wall within 4 feet of a weatherproof receptacle. Use fasteners supplied, one at the top and one at the bottom of the unit. Mount the box a minimum of 12" above the ground.

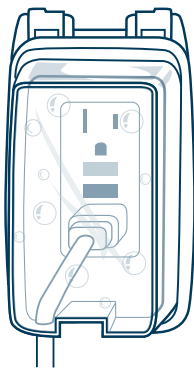
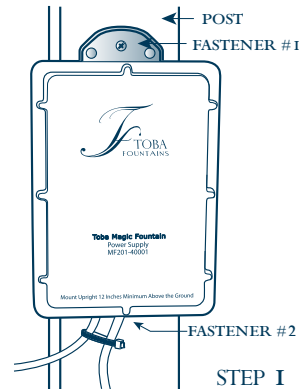

THE RECEPTACLE MUST BE WEATHER-PROOF WITH THE POWER CORD INSTALLED.

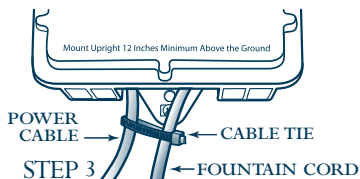

## CAUTION:

*Do not operate the fountain with the weatherproof box laying down horizontally. This can allow water to enter the bottom of the unit which will cause a hazardous condition and void the warranty.*

*Note: Outlet box must be a “Weatherproof In Use” GFCI type receptacle. See figure 1 Consult a licensed electrician to install the proper weatherproof GFCI outlet.*

**STEP 2:** Place the fountain on the ground near the pond and lay the power cord where you intend it to go leading up to the power supply.

**STEP 3:** Plug the long fountain cord into the power supply receptacle and secure it as shown with the cable tie provided. This will help to keep the cord from pulling out.

## SETTING UP YOUR MAGIC FOUNTAIN CONT'D:

**STEP 4:** Select 3 fountain heads and install in the three outlet holes in the fountain. Press and rotate slightly to get a snug fit. Do not use excessive force.

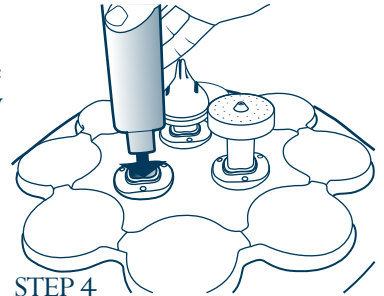

**STEP 5:** Open the battery compartment on the remote control and install 3 AAA batteries as shown. Replace the battery cover - Do not overtighten the screws.

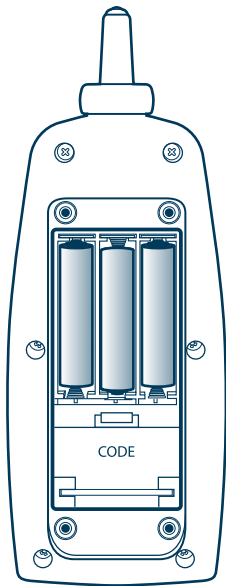

**STEP 6:** Attach the anchor. Unwind the anchor cable from the bottom of the anchor as needed and attach the anchor to the bottom of the fountain. Leave enough slack in the anchor cord to allow for normal changes in water level.

**NOTE:** *The Toba Magic Fountain is designed to float freely in the water such that changes in water level do not affect the operation of the pump. Do not allow the water level to go below 12" in the area where the fountain is floating.*

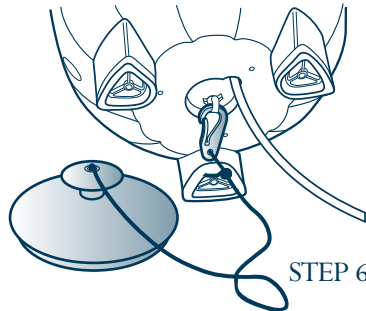

**STEP 7:** Install the 3 filters. Make sure that all three filters are inserted into the slots in the lower part of the fountain. DO NOT operate the fountain without all 3 filters in place. This will keep the fountain heads and pump from getting clogged with dirt or algae.



## PLACING THE FOUNTAIN IN THE POND:

**STEP 8:** Turn on the power supply and then turn on the power switch on the fountain. The green light should illuminate on the fountain control panel. If a red light comes on, refer to troubleshooting to diagnose the problem. Do not press the water or lights test switches.

**STEP 9:** Position the fountain and anchor in the pond in the area you choose. The anchor positioner fitting for your standard skimmer pole is provided to help in placing and retrieving the fountain in deep water.

**NOTE:** ***DO NOT** use the power cable to keep the fountain located in the center of the pond. Constant pulling on the cable will damage the wires over time. For the same reason, do not place the anchor on top of the power cable. If you wish to bury the cable with gravel or sand, be careful to place it in an area where it will not be damaged by digging.*

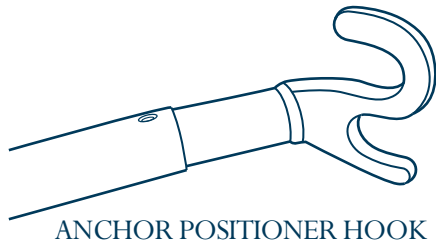
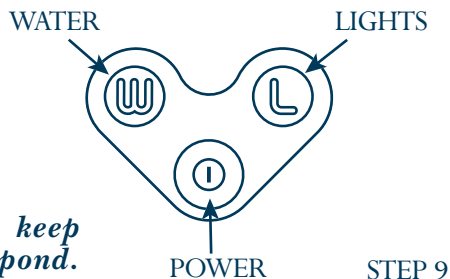
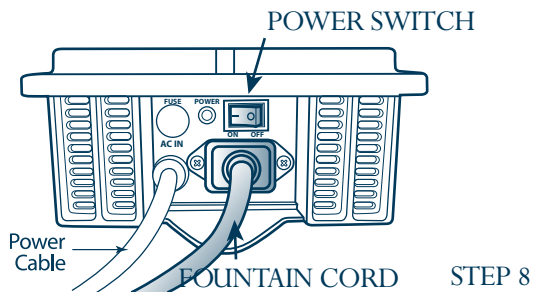

**STEP 10:** Test the fountain by pushing the ON button on the remote control.

## FOUNTAIN OPERATION:

### REMOTE CONTROL

The **RF** remote controls all the function of the fountain. It operates on a radio frequency (**RF**). This allows you to operate the fountain from a longer distance, even from inside your home. The working range depends on local conditions and may be decreased somewhat by buildings or walls. Under normal use, the batteries should last for 1-2 months.

If the fountain does not respond to the remote control, first try moving closer or replacing the remote control batteries. Also, make sure that the power switch on the fountain is turned on and the light near the switch is green. If the light near the switch is Red, there is an internal problem with the fountain. Refer to the troubleshooting section.

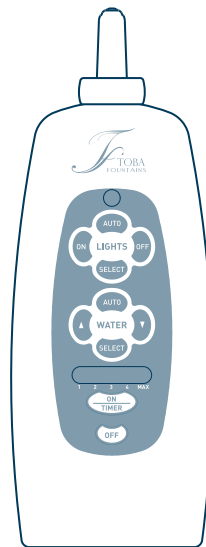

### FOUNTAIN MODES

The **ON** button on the remote control is used to turn on the fountain and also to set the Auto Shut-Off timer. If you push the **ON** button once, the fountain will come on and then automatically shut off in 1 hour. If you push the **ON** button twice, the time advances to 2 hours as shown on the Timer indicator. Each time you push the **ON** button the time advances. The **MAX** setting is 8 hours.

Three seconds after the last button is pushed, the **ON** signal and Shut-Off time are sent to the fountain. The timer indicator will turn off after 5 more seconds.

If the fountain is already running and you select a new Auto Shut-Off time, the fountain spray will drop down for one second and then resume, indicating that the new timer signal has been received.

## **WATER**

The default mode for the water is **AUTO** (automatic). In this mode, the fountain operates the current fountain head for one minute and then changes to the next style for one minute. The cycle keeps changing until you turn off the fountain or the automatic timer shuts it off.

If you wish to cancel the **AUTO** operation, push the **SELECT** button. The fountain will remain on the selected style. If you push the **SELECT** button again, the fountain will change to the next style and remain on that style. Pressing the **AUTO** button will return the mode to automatic.

## **WATER HEIGHT**

You can adjust the water height by pressing the **↑** and **↓** buttons. When you turn off the fountain and turn it on again with the remote control, it will remember the water height you set last.

## **LIGHTS**

You control the lights with the lights **ON** and lights **OFF** buttons on the remote control. The normal mode is **AUTO**, similar to

the water. The lights will change every 45 seconds to the next color, cycling through all the colors continuously. If you wish to cancel the **AUTO** function, press the **SELECT** button. The current light color will remain on. If you push the **SELECT** button again, the lights will change to the next light color and remain on that color. Pressing the **AUTO** button will return the mode to automatic.

**FOUNTAIN SWITCH PANEL** - Located on the Fountain

The **POWER** button on the fountain switch panel is used to turn the main power on and off. Remember to turn on the fountain before you place it in the pond, and turn it off when you remove it from the pond to avoid accidental remote control signals from turning on the fountain when it is out of the water.

The power light will be **Green** when power is on. If a fault condition is detected, the light will change to **Red** and the fountain will shut off. If this occurs, refer to **Troubleshooting**.

The **Water** and **Lights** buttons on the fountain are used for troubleshooting the fountain and for checking the light bulbs.

### FILTER SCREENS

Your fountain is designed to require very little maintenance. The most important thing is to regularly clean the three filter screens. Just slide out each screen, rinse them off and replace. **DO NOT** run the fountain without all three screens in place. Replacement screens can be ordered at [www.tobafountains.com](http://www.tobafountains.com). Periodically check the fountain heads as well for algae or other dirt and clean in running water.

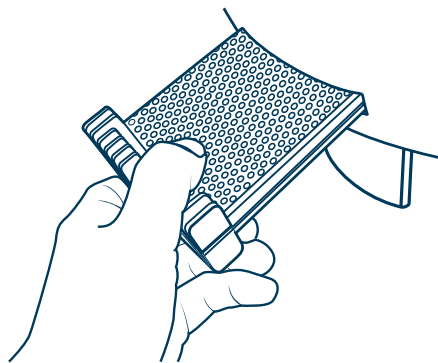

### LIGHT BULB REPLACEMENT

What you will need: Dry soft cloth, replacement bulbs.

**CAUTION:** *Use only 12 volt 20 watt maximum MR-11 style Halogen Bulbs. Use of a higher wattage bulb will generate excessive heat and void the warranty. Replacement bulbs can be purchased at your local home store or direct from [www.tobafountains.com](http://www.tobafountains.com)*

**STEP 1:** Remove fountain from pond and check to see which bulb is burned out. Push the W (water) and L (lights) buttons at the same time and hold for 2 seconds. Each pair of lights will come on for 1 second, going around the circle. Remove the colored lens cover from the light that needs to be changed.

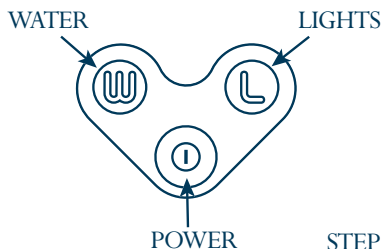

**STEP 2:** Turn off power to the fountain at the Power Supply.

**STEP 3:** Remove water from around the bulb area by laying the fountain on it's side until all the water drains from the top cover. Return the fountain to upright.

**STEP 4:** Remove the clear plastic lamp cover by turning counter-clockwise 1/8 th of a turn. The plastic cover will come off leaving the glass cover underneath. Remove the glass cover and place on the soft cloth.

**STEP 5:** Remove the bulb by grasping the metal clip and pulling upward.

**STEP 6:** Remove the old bulb from the clip and replace it with a new bulb. Replace the bulb in the socket - note the position of the pins.

**STEP 7:** Inspect the O-Ring seal and the glass to make sure they are both clean and dry, then replace the glass. Avoid getting finger prints on the glass.

**STEP 8:** Replace the clear plastic cover and lock by turning clockwise until it snaps into place. Replace the colored lens. Make sure that colored lenses on opposite sides of the fountain are the same color.

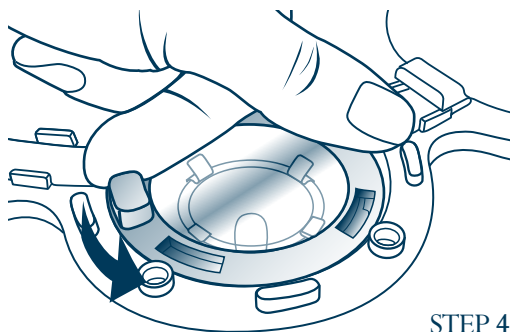
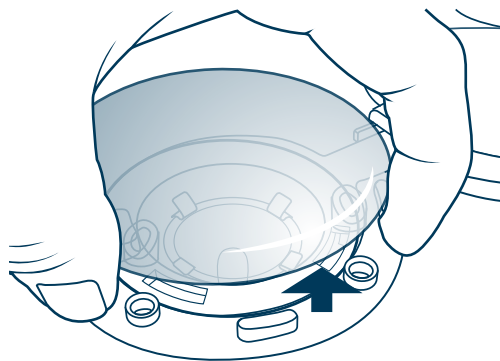

STEP 4

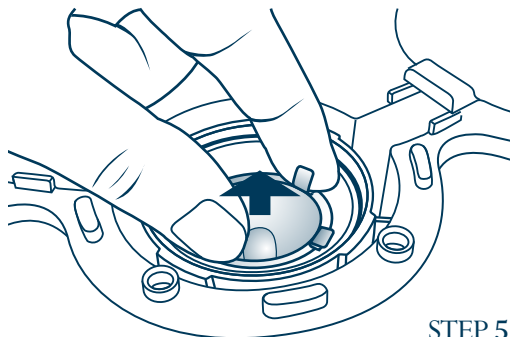

STEP 5

## HOW TO CHANGE THE FREQUENCY CODE:

The RF remote control operates up to 150 feet in ideal conditions even from inside your home. This can cause interference between your fountain and your neighbor's fountain. If you notice this problem, you can change the code for your remote control and your fountain.

**STEP 1:** Open the remote control battery door and locate the small door marked **CODE**.

Open the door. Next, open the triangular door on the top of the fountain marked **FUSE**.

**STEP 2:** In each compartment you will see a switch with 8 tabs. The position of each tab will be the same on the remote and the fountain, either up or down. To change the code, choose switch and change it on both the fountain and the remote. You may want to use a small screwdriver or a ballpoint pen to change the position of the tab. When you are finished, make sure the tabs on the remote exactly match the tabs on the fountain.

**STEP 3:** Close both remote and fountain panels carefully and test. There are 256 possible code combinations.

**TIP:** If you have more than one fountain or if you purchase a second remote control from the Toba Fountains website [www.tobafountains.com](http://www.tobafountains.com), you can set two fountains to operate on the same code, or set two remotes to operate the same fountain.

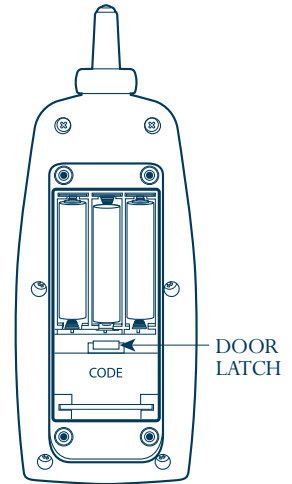

STEP 1

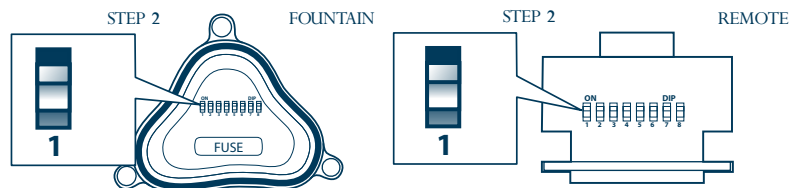

## TROUBLESHOOTING:

### **NO RESPONSE FROM THE REMOTE CONTROL:**

First try moving to another location or move closer to the fountain. Radio interference from other devices in the home or from structures in your home can cause the signal to be weaker.

If the fountain still does not respond, try new batteries in the remote.

### **THE FOUNTAIN DOES NOT TURN ON EVEN WHEN CLOSE TO THE REMOTE CONTROL:**

Check the power panel on the fountain. The power light should be green. If no light is on, check the power supply.

If the fountain power light is red, then a problem has occurred that needs attention.

### **THE FOLLOWING THINGS CAN CAUSE A FAULT CONDITION.**

1. Blockage of the pump or valve mechanism – possibly caused by ice or dirt.
2. Low voltage condition caused by a problem with the power cable or the power supply.
3. No water or low water condition.

If you suspect that there is ice in the fountain, remove the fountain from the pond, remove the fountain heads and the three filters and pour warm (not hot) water backwards through the fountain head outlet holes. One outlet will be open and water should run freely through and out of the filter slots. If there is too much ice, move the fountain to a warm area until all the ice melts and flush with water.

If cleaning of the fountain heads or the internal plumbing corrects the blockage, the fault condition can be reset by turning the fountain off and on with the fountain power switch.

If the fault condition persists and you have checked that the power to the outlet is ok, please visit the Toba website at [www.tobafountains.com](http://www.tobafountains.com) for more assistance. You can also call our Customer Service department at (800) 985-TOBA M-F 9am – 5pm Pacific time.

## TOBA FOUNTAINS LIMITED WARRANTY:

(Valid in USA only)

Toba Fountains LLC (“Toba”) warrants to the original retail purchaser that this product is free from defects in material or workmanship under the condition of normal residential use and service for a period of twelve (12) months from the date of purchase. This warranty does not cover use or installation of the product in a non-residential establishment, or in either a marine or saltwater environment. The product is usable with salt filtration systems, but not saltwater pools or ponds. This limited warranty is void if the product has been subject to misuse, tampering, neglect, accident, or unauthorized alterations or repairs. This limited warranty is void if the serial number or date code has been removed, altered, or defaced.

In the event that a defect, malfunction, or failure occurs or is discovered during the warranty period, Toba will, at its option, repair or replace the product or component part(s) which are determined in the reasonable judgment of Toba to be defective or not to factory specifications or refund the purchase price. To obtain performance of this limited warranty, you must: (a) contact Toba Service Department and receive a Return Authorization (RA), and (b) properly package and ship to Toba the product along with a legible copy of the original sales receipt or other proof of purchase acceptable to Toba and a statement listing the RA number and describing the defect or malfunction. Any return shipment that does not have an RA number clearly shown on the package label will not be accepted. Toba may, at its option, direct you to return only the defective portion of the product to minimize shipping charges. All transportation costs and risk of loss or damage for shipments to Toba shall be borne by the owner. All items repaired or replaced under this limited warranty shall be subjected to the same limited warranty for a period of twelve (12) months from the date that Toba ships the repaired or replaced product. Parts used in repairing or servicing Product may be new, equivalent-to-new, or reconditioned. For repairs covered by this limited warranty, Toba will pay for shipping the product back to the owner. If any repairs are necessary and are not covered by this limited warranty, the owner will be responsible for the costs of the repairs and the return transportation costs.

**THIS LIMITED WARRANTY IS IN LIEU OF ALL OTHER WARRANTIES EXPRESSED OR IMPLIED, INCLUDING THE IMPLIED WARRANTIES OF MERCHANTABILITY AND FITNESS FOR A PARTICULAR PURPOSE WHICH ARE EXPRESSLY EXCLUDED OR DISCLAIMED. TOBA SHALL NOT BE RESPONSIBLE FOR CONSEQUENTIAL, INCIDENTAL, SPECIAL, PUNITIVE OR OTHER DAMAGES, AND TOBA EXPRESSLY EXCLUDES AND DISCLAIMS LIABILITY FOR ANY DAMAGES RESULTING FROM THE USE, OPERATION, IMPROPER APPLICATION, MALFUNCTION OR DEFECT OF ANY TOBA PRODUCT COVERED BY THIS LIMITED WARRANTY. TOBA'S OBLIGATIONS UNDER THIS LIMITED WARRANTY ARE STRICTLY AND EXCLUSIVELY LIMITED TO THE REPLACEMENT OR REPAIR OF ANY DEFECTIVE PRODUCT OR COMPONENT PART(S). IF TOBA IS UNABLE TO REPLACE OR REPAIR THE PRODUCT, THE TOTAL LIABILITY OF TOBA SHALL NOT EXCEED THE PRICE PAID FOR THE PRODUCT.**

**SOME STATES DO NOT ALLOW THE EXCLUSION OR LIMITATION OF INCIDENTAL OR CONSEQUENTIAL DAMAGES, SO THE ABOVE LIMITATION OR EXCLUSION MAY NOT APPLY TO YOU. THE TERM OF ANY IMPLIED WARRANTIES THAT CANNOT BE DISCLAIMED ARE LIMITED TO THE TERM OF THIS LIMITED WARRANTY. TOBA DOES NOT ASSUME OR AUTHORIZE ANYONE TO ASSUME FOR IT ANY OTHER OBLIGATION WHATSOEVER. SOME STATES DO NOT ALLOW LIMITATION, RESTRICTIONS OR MODIFICATIONS OF IMPLIED WARRANTIES UNDER APPLICABLE LAW, SO THE ABOVE LIMITATIONS MAY NOT APPLY TO YOU. IT IS THE OWNER/USER'S RESPONSIBILITY TO COMPLY WITH LOCAL, STATE, OR FEDERAL REGULATIONS, IF ANY, THAT MAY PERTAIN TO TOBA PRODUCTS OR THEIR USE. THIS WARRANTY GIVES YOU SPECIFIC LEGAL RIGHTS, AND YOU MAY ALSO HAVE OTHER RIGHTS WHICH VARY FROM STATE TO STATE.**

**ANY CLAIM, DISPUTE OR CONTROVERSY RELATING TO TOBA FOUNTAINS OR ITS PRODUCTS SHALL, TO THE MAXIMUM EXTENT PERMITTED BY APPLICABLE LAW, BE GOVERNED BY THE**

## TOBA FOUNTAINS LIMITED WARRANTY CONT'D:

LAWS OF THE STATE OF CALIFORNIA, WITHOUT REGARD TO CONFLICTS OF LAWS RULES AND SHALL BE RESOLVED EXCLUSIVELY AND FINALLY BY BINDING ARBITRATION GOVERNED BY FEDERAL ARBITRATION ACT 9 U.S.C. SEC. 1-16 AND HELD IN LOS ANGELES, CALIFORNIA AND ADMINISTERED BY THE AMERICAN ARBITRATION ASSOCIATION (AAA).

If you experience difficulty in the operation of your product, or if your product requires service please contact: Toba Service Department 800.985.TOBA

---

### F C C COMPLIANCE:

The Toba Magic Fountain complies with the limits for a Class B digital device, pursuant to Part 15 of the FCC rules. These limits are designed to provide reasonable protection against harmful interference in a residential installation. This equipment generates, uses and can radiate radio frequency energy and, if not installed and used in accordance with the instructions, may cause harmful interference to radio communications.

However, there is no guarantee that interference will not occur in a particular installation. If this equipment does cause harmful interference to radio or television reception, which can be determined by turning the equipment off and on, the user is encouraged to try to correct the interference by one or more of the following measures:

- Reorient or relocate the radio or television receiving antenna
- Increase the separation between the equipment and receiver.
- Connect the equipment into an outlet on a circuit different from that to which the receiver is connected.
- Consult the dealer or an experienced radio/TV technician for help.

Warning: Changes or modification to this unit not expressly approved by the party responsible for compliance could void the user's authority to operate the equipment.

IC: 6682A-REMOTE

IC: 6682A-FOUNTAIN

Transmitter Frequency: 433.92 Mhz

SERIAL NUMBER



BRINGING WATER TO LIFE

15622 PRODUCER LANE  
HUNTINGTON BEACH, CA 92649

[WWW.TOBAFOUNTAINS.COM](http://WWW.TOBAFOUNTAINS.COM)

800-985-TOBA

MADE IN CHINA

MF201-16005